



C 730 Series*

10 KVDC High Voltage Lead Assemblies and Receptacles

Altitude Rated
For Limited Military/Aerospace Applications
Operating Temperature:
-55°C to +95°C

C 730 Series

10 KVDC Shielded & Non-Shielded Lead Assemblies

P/N 7RC1500 Positive Stop (ferrule)



P/N RC1500 Non-Positive Stop (washers)



17R1500 Positive Stop (ferrule)

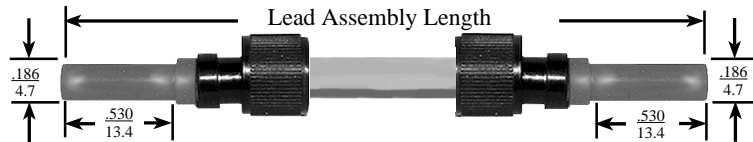

P/N 3R1500 Non-Positive Stop (washers)

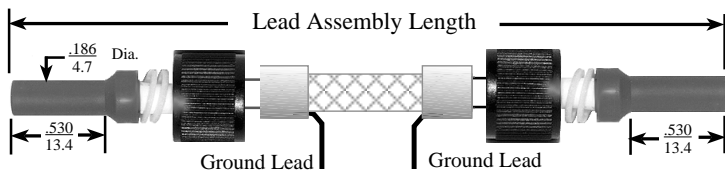

P/N 2RC1500 Non-Positive Stop (washers)

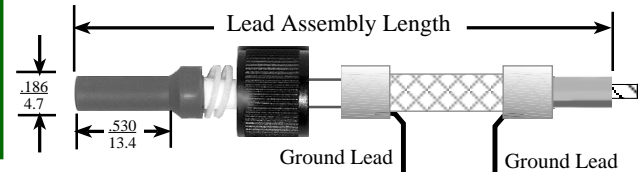

C 730 Series Functional Characteristics

Operating voltage: 10 KVDC any altitude to 70,000 ft. • Operating temperature: -55°C to +95°C
Mating connectors: All C 730 series receptacles • All series 730 receptacles • All LGH 1/2I series receptacles.
Wire type: White 0.160 Dia. silicone rubber. #AWG 16

Ordering Cable Assemblies

Use -XLX to specify cable assembly length:
X=feet L X=inches Example: 4L6 is 4 feet, 6 inches

Note: Stranded wire shown on single-ended assemblies is for factory testing and is not included in length dimension

C 730 Series

10 KVDC Receptacles

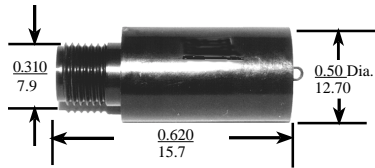

P/N RC1505

Operating voltage: 10 KVDC to 70,000 ft.
Operating temperature: -55°C to +95°C
Mating connectors:
All C 730 lead assemblies
All series 730 lead assemblies
All LGH 1/2I lead assemblies

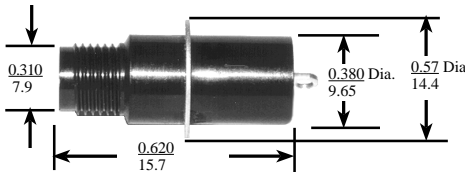

P/N 2RC1505

Operating voltage: 10 KVDC to 70,000 ft.
Operating temperature: -55°C to +95°C
Mating connectors:
All C 730 lead assemblies
All series 730 lead assemblies
All LGH 1/2I lead assemblies
Solder flange: Brass with tin plate

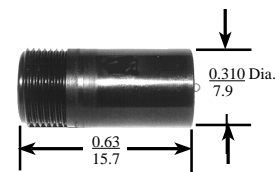

P/N 3RC1505

Operating voltage: 10 KVDC to 70,000 ft.
Operating temperature: -55°C to +95°C
Mating connectors:
All C 730 lead assemblies
All series 730 lead assemblies
All LGHI 1/2I lead assemblies

Test Voltage: 15 KVDC
Lead Assemblies and Receptacles
are 100% tested at sea level.

* In 1997, Reynolds Industries, Inc. acquired the RLA 1500 and 1505 Series as depicted above from Rowe Industries, Inc. The RLA Series has been re-named C Series and retains its functional design.