

Series 730/830 HI-REL 10 KVDC

Altitude Rated
For Military/Aerospace Applications
Operating Temperature:
-55°C to +125°C

Plugs

Plug 730 Series (plastic coupling nut)

P/N 167-9151 Silicone insulator for .090 Dia. wire
P/N 167-9219 Silicone insulator for .150 Dia. wire

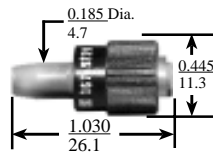

Plug 830 Series (metal coupling nut)

P/N 167-8810 Silicone insulator for 0.090 Dia. wire
P/N 167-8811 Silicone insulator for 0.150 Dia. wire

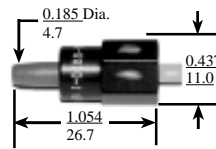

Series 730/830 Plug Attributes

Operating voltage: 10 KVDC up to 70,000 ft.
Mating: Mates all series 730 & 830 receptacles and LGH 1/2I series receptacles. Also mates Reynolds C730 series RC1505, 2RC1505 and 3RC1505 receptacles. Note: This combination will reduce the upper operating temperature from +125°C to +95°C
For cable preparation and assembly instructions, see pp. 46 & 47
Bulk cable: See p. 40 for ordering and specifications

Receptacles

Receptacle (front mount, sealed)

P/N 167-9158 Silicone seals
P/N 167-9275 Fluorosilicone seals

Leak Test: 1 X 10⁻⁶ cc/sec. He.

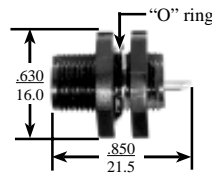

Receptacle Right Angle (front mount, sealed)

P/N 167-9228 Silicone seals
P/N 167-9294 Fluorosilicone seals

Leak Test: 1 X 10⁻⁶ cc/sec. He.

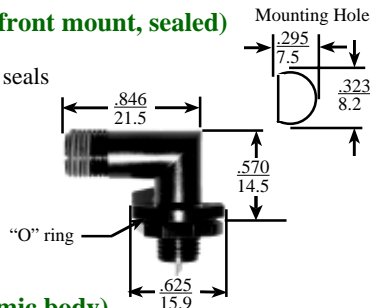

Receptacle (flanged ceramic body)

P/N 167-8626 Ceramic-to-metal hermetic seal. Front mount.

Leak Test: 1 X 10⁻⁸ cc/sec. He.
Flange Material: Iron nickel alloy with Gold Plate

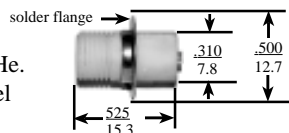

Series 730 Receptacle Attributes

Operating voltage: 10 KVDC up to 70,000 ft.
Pressure: Sealed for 15 psi differential pressure.
Ordering: Use the applicable Part Number
Mating: Mates all Series 730, 830 and LGH 1/2I lead assemblies. Also mates all 10 KVDC rated Reynolds C730 lead assemblies; this combination will reduce the upper operating temperature from +125°C to +95°C.

Cable Assemblies

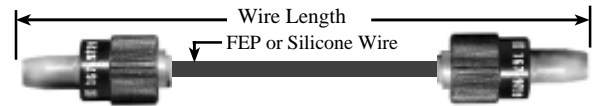

Series 730 Double-Ended Cable Assembly

P/N 167-9872 .080 FEP wire & P/N 167-9151 connectors
P/N 167-9210 .150 silicone wire & P/N 167-9219 connectors
P/N 167-9875 .080 FEP wire & P/N 167-9274 connectors using fluorosilicone rubber insulators

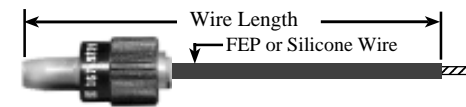

Series 730 Single-Ended Cable Assembly

P/N 167-9876 .080 FEP wire & P/N 167-9151 connector
P/N 167-9213 .150 silicone wire & P/N 167-9219 connector
P/N 167-9879 .080 FEP wire & P/N 167-9274 connector using a fluorosilicone rubber insulator

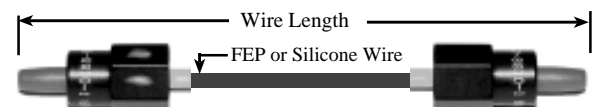

Series 830 Double-Ended Cable Assembly (metal coupling nut)

P/N 167-8813 .080 FEP wire & P/N 167-8810 connectors
P/N 167-8815 .150 silicone wire & P/N 167-8811 connectors
P/N 167-8855 .080 FEP cable & P/N 167-8782 connectors using fluorosilicone rubber insulators

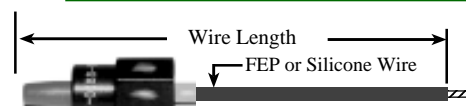

Series 830 Single-Ended Cable Assembly (metal coupling nut)

P/N 167-8812 .080 FEP wire & P/N 167-8810 connector
P/N 167-8814 .150 silicone wire & P/N 167-8811 connector
P/N 167-8854 .080 FEP wire & P/N 167-8782 connector using a fluorosilicone rubber insulator

Series 730/830 Cable Assembly Attributes

Operating voltage: 10 KVDC up to 70,000 ft.
Test Voltage: 15 KVDC @ 70,000 ft. (simulated) ambient temp.
Mating connectors: Mates all series 730 & 830 receptacles and all LGH 1/2I series receptacles. Also mates Reynolds C730 receptacles RC1505, 2RC1505 and 3RC1505; this combination will reduce the upper operating temperature from +125°C to +95°C
Ordering: See Cable Assembly Ordering Information, below
Bulk wire & cable: See p. 40 for ordering and specifications

Cable Assembly Ordering Information

Order by Part Number
Use "F" for feet, "N" for inches.
Example: Cable Assembly 167-9872 10 feet 8 inches in length, is ordered as P/N 167-9872-10F-8N