



C 720 Series*

20 KVDC High Voltage Lead Assemblies and Receptacles

Altitude Rated
For Limited Military/Aerospace Applications
Operating Temperature:
-55°C to +95°C

C 720 Series 20 KVDC Shielded & Non-Shielded Lead Assemblies

P/N 21RC1520 Positive Stop (ferrule)

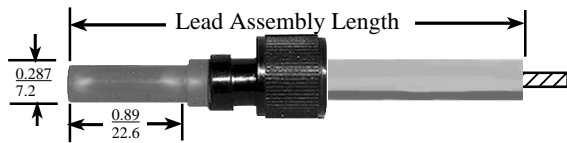

P/N RC1520 Non-Positive Stop (washers)

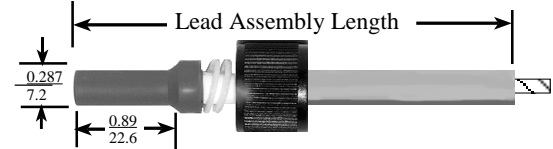

P/N R1520 Non-Positive Stop (washers)

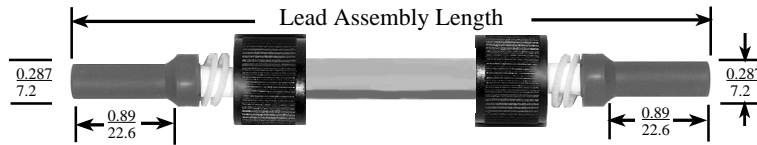

P/N 178-6093 Non-Positive Stop (washers)

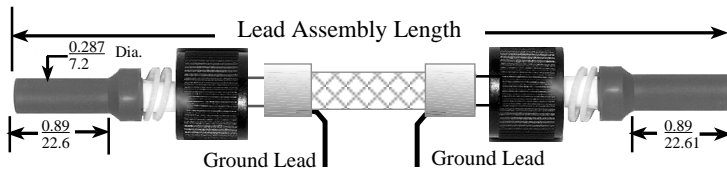

P/N 178-6094 Non-Positive Stop (washers)

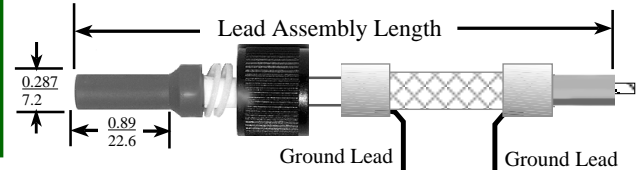

C 720 Series Functional Characteristics

Operating voltage: 20 KVDC any altitude to 70,000 ft. • Operating Temperature: -55°C to +95°C
Mating connectors: All C 720 series receptacles • All series 720 receptacles • All LGH LI series receptacles
Cable type: White 0.265 Dia. silicone rubber. #AWG 16

Ordering Cable Assemblies

Use -XLX to specify cable assembly length:
X=feet L X=inches Example: 4L6 is 4 feet, 6 inches

Note: Stranded wire shown on single-ended assemblies is for factory testing and is not included in length dimension

C 720 Series 20 KVDC Receptacles

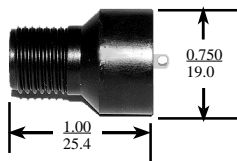

P/N RC1525

Operating voltage: 20 KVDC to 70,000 ft.
Operating temperature: -55°C to +95°C
Mating connectors:
All C 720 1520 Lead assemblies
All LGH II series lead assemblies
All series 720 lead assemblies

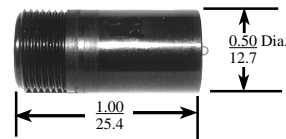

P/N 3RC1525

Operating voltage: 20 KVDC to 70,000 ft.
Operating temperature: -55°C to +95°C
Mating connectors:
All C 720 1520 lead assemblies
All LGH II series lead assemblies
All series 720 lead assemblies

Test Voltage: 25 KVDC
Lead Assemblies and Receptacles
are 100% tested at sea level.

* In 1997, Reynolds Industries, Inc. acquired the RLA 1520 and 1525 Series as depicted above from Rowe Industries, Inc. The RLA Series has been re-named C Series and retains its functional design.